

### FEATURES

- Two fully independent diodes
- Fully insulated package
- Ultrafast ,soft reverse recovery,with high operation junction temperature (175°C T<sub>j</sub>)
- Low forward voltage drop
- Optimized for power conversion:welding and industrial SMPS applications
- Easy to use and parallel
- Industry standard outline
- Designed and qualified for industrial level

SOT-227

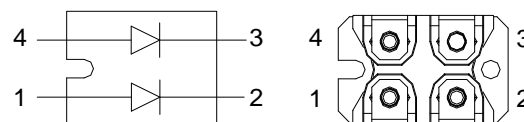

### DESCRIPTION

The JK2U240-20 insulated modules integrate two state of the Art Ultrafast recovery rectifiers in the compact, industry standard SOT-227 package. The diodes structure, and its life time control, provide an ultrasoft recovery current shape, together with the best overall performance, ruggedness and reliability characteristics.

These devices are thus intended for high frequency applications in which the switching energy is designed not to be predominant portion of the total energy, such as in the output rectification stage of welding machines, SMPS, DC/DC converters. Their extremely optimized stored charge and low recovery current reduce both over dissipation in the switching elements (and snubbers) and EMI/RFI.

### PRODUCT SUMMARY

TYPE	I <sub>F(AV)</sub>	VR
JK2U240-20	240A	200V

### ABSOLUTE MAXIMUM RATINGS

PARAMETER	SYMBOL	TEST CONDITIONS	MAX	UNIT
Cathode to anode voltage	VR		200	V
Continuous forward current per diode	I <sub>F</sub> <sup>(1)</sup>	T <sub>C</sub> =95°C	175	A
Single pulse forward current per diode	I <sub>FSM</sub>	T <sub>C</sub> =25°C	1700	A
Maximum power dissipation per module	PD	T <sub>C</sub> =95°C	372	W
RMS isolation voltage	V <sub>isol</sub>	Any terminal to case, t=1 minute	2500	V
Operating junction and storage temperatures	T <sub>J</sub> , T <sub>stg</sub>		-55 to 175	°C

### NOTE

(1) Maximum continuous forward current must be limited to 100A to do not exceed the maximum temperature of power terminals.

# J K2U240 -20 Series

ELECTRICAL SPECIFICATIONS						
PARAMETE	SYMBOL	TEST CONDITIONS	MIN	TYP	MAX	UNITS
Cathode to anode breakdown voltage	VBR	IR=100μA	200	-	-	V
Forward voltage	VFM	IF=120 A	-	0.9	1.3	
		IF=120 A TJ=175°C	-	0.8	0.90	
Reverse leakage current	IRM	VR=VR rated	-	1	50	μA
		VR=VR rated TJ=175°C	0.36	-	4	mA
Junction capacitance	CT	VR=200V		100		pF

DYNAMIC RECOVERY CHARACTERISTICS (TJ=25°C unless otherwise specified)						
PARAMETE	SYMBOL	TEST CONDITIONS	MIN	TYP	MAX	UNITS
Reverse recovery time	trr	IF=0.5A,IR=1A,IRR=0.25A TJ=25°C	-	85	100	nS
Peak recovery current	IRRM	TJ=25°C		5.1		A
		TJ=125°C		10.3		
Reverse recovery charge	Qrr	TJ=25°C		87		nC
		TJ=125°C		300		

THERMAL-MECHANICAL SPECIFICATIONS						
PARAMETE	SYMBOL	TEST CONDITIONS	MIN	TYP	MAX	UNITS
Junction to case ,single leg conducting	Rthjc		-	-	0.43	°C/w
Junction to case ,both leg conducting			-	-	0.215	
Case to heatsink	Rthcs	Flat,greased surface		0.05		
Weight				30		g
Mounting torque				1.3		Nm
Case style			SOT-227			

## Ordering Information Tabel

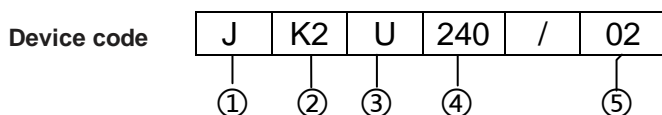

- ① JH 's power module
- ② Circuit configuration (2 separate diodes ,parallel pin-out)
- ③ U for Ultrafast rectifier
- ④ Maximum average forward current (240A)
- ⑤ Voltage rating (02 = 200V)

# J K2U240 -20 Series

## Performance Curves

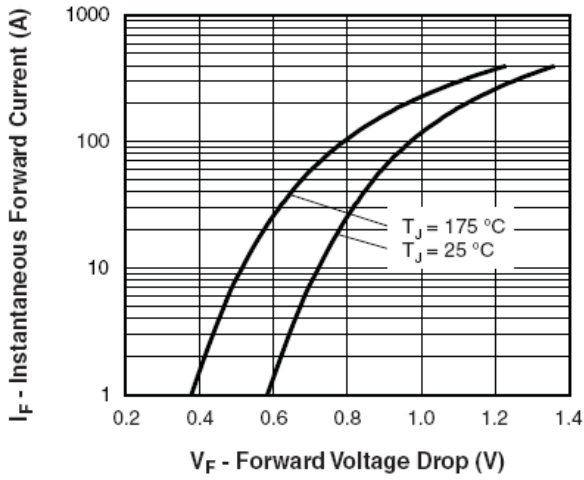

Fig. 1 - Typical Forward Voltage Drop Characteristics (Per Diode)

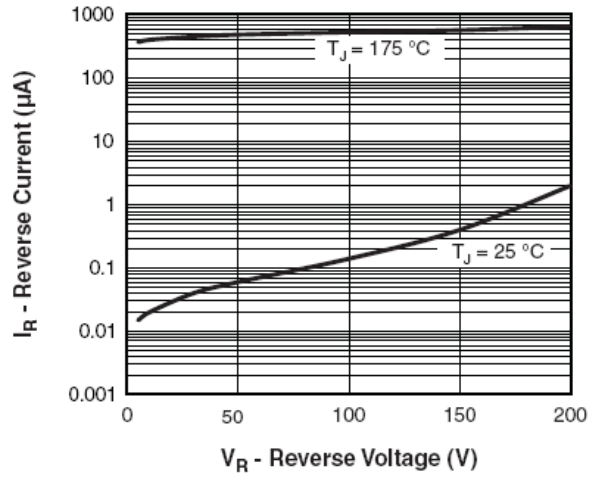

Fig. 2 - Typical Values of Reverse Current vs. Reverse Voltage

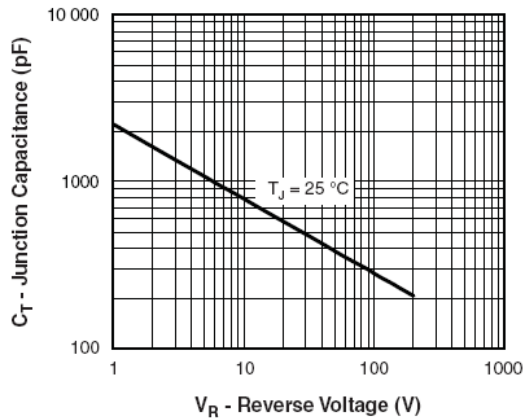

Fig. 3 - Typical Junction Capacitance vs. Reverse Voltage

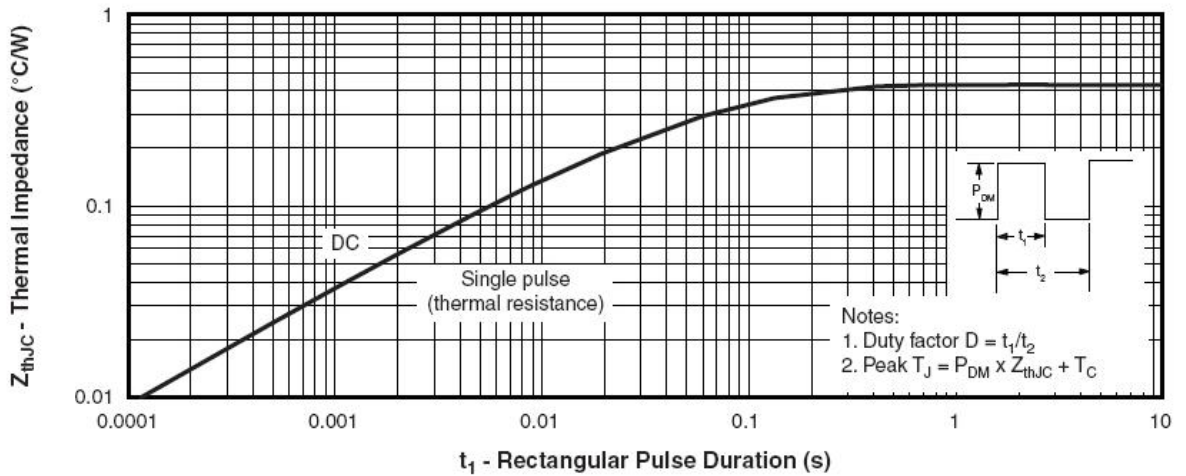

Fig. 4 - Maximum Thermal Impedance  $Z_{thJC}$  Characteristics (Per Leg)

# JK2U240 -20 Series

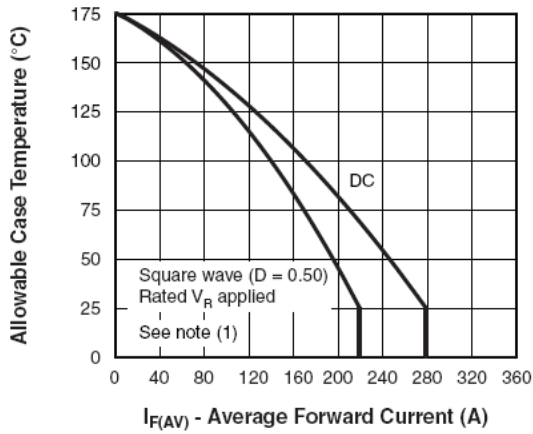

Fig. 5 - Maximum Allowable Case Temperature vs. Average Forward Current (Per Leg)

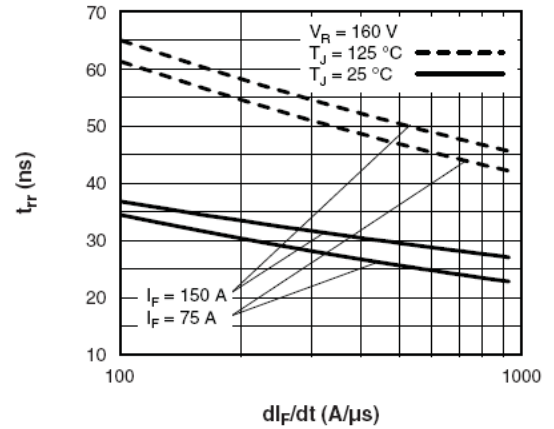

Fig. 7 - Typical Reverse Recovery Time vs.  $di_F/dt$

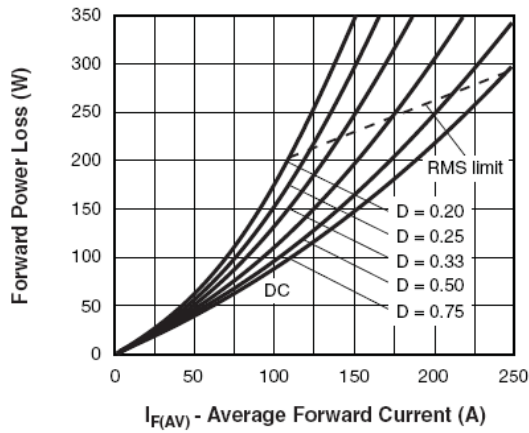

Fig. 6 - Forward Power Loss Characteristics (Per Leg)

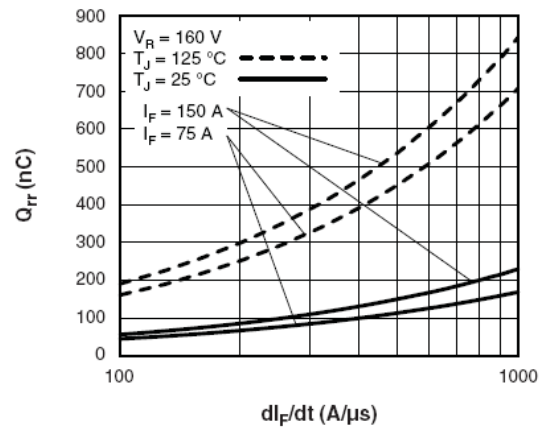

Fig. 8 - Typical Stored Charge vs.  $di_F/dt$

## Note

- (1) Formula used:  $T_C = T_J - (Pd + Pd_{REV}) \times R_{thJC}$ ;  
 $Pd$  = Forward power loss =  $I_{F(AV)} \times V_{FM}$  at  $(I_{F(AV)}/D)$  (see fig. 6);  
 $Pd_{REV}$  = Inverse power loss =  $V_{R1} \times I_R (1 - D)$ ;  $I_R$  at  $V_{R1} = 80\%$  rated  $V_R$

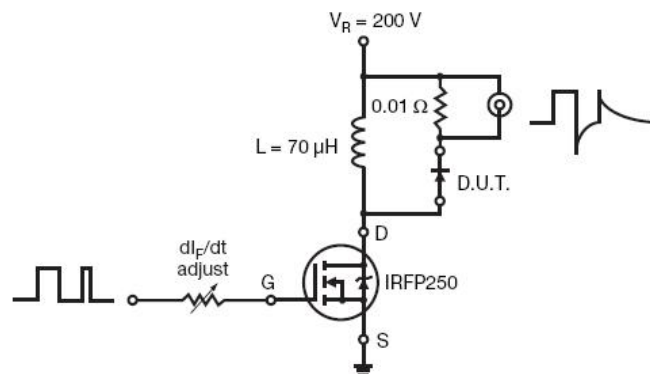
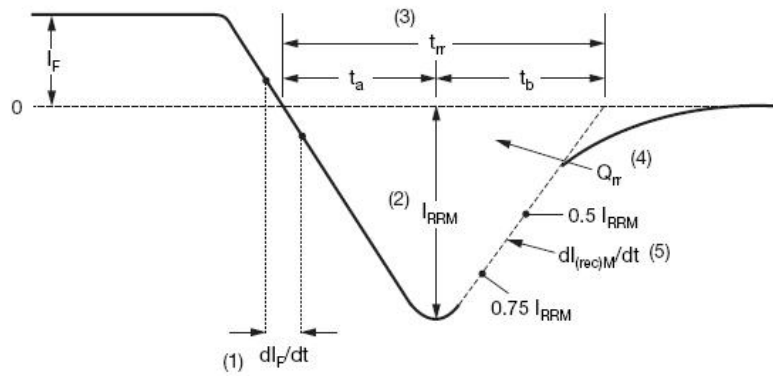

Fig. 9 - Reverse Recovery Parameter Test Circuit

# JK2U240 -20 Series



(1)  $dl_F/dt$  - rate of change of current through zero crossing

(2)  $I_{RRM}$  - peak reverse recovery current

(3)  $t_{rr}$  - reverse recovery time measured from zero crossing point of negative going  $I_F$  to point where a line passing through  $0.75 I_{RRM}$  and  $0.50 I_{RRM}$  extrapolated to zero current.

(4)  $Q_{rr}$  - area under curve defined by  $t_{rr}$  and  $I_{RRM}$

$$Q_{rr} = \frac{t_{rr} \times I_{RRM}}{2}$$

(5)  $dl_{(rec)M}/dt$  - peak rate of change of current during  $t_b$  portion of  $t_{rr}$

Fig. 10 - Reverse Recovery Waveform and Definitions

DIMENSIONS in millimeters

SOT-227 package

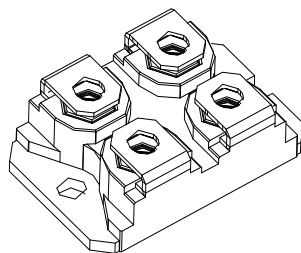
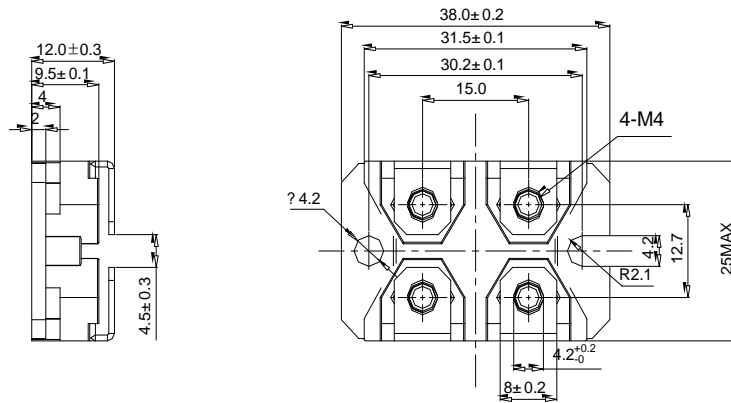

## Friendship Reminder

■ JiNan JingHeng (hereinafter referred to as JH) reserves the right to make changes to this document and its products and specifications at anytime without notice.

济南晶恒（以下简称 JH）保留未经通知，变更本文件和与本文件相关的产品及规格的权利。

■ Customers should obtain and confirm the latest product information and specifications before final design, purchase or use.

使用方应在使用、采购本产品之前获取并确认产品信息和规格书的最新版本。

■ JH makes no warranty, representation or guarantee regarding the suitability of its products for any particular purpose, nor does JH assume any liability for application assistance or customer product design.

JH 对其产品用于某特定用途的适用性，既不做任何保证、说明或担保，也不承担任何应用协助或使用方设计的法定责任。

■ JH does not warrant or accept any liability with products which are purchased or used for any unintended or unauthorized application.

JH 不保证或承担任何责任，其产品被采购使用于任何非预期或授权的应用，

■ No license is granted by implication or otherwise under any intellectual property rights of JH.

此规格书属于 JH 的知识产权,没有经过我司授权不得抄袭。

■ JH's products are not authorized for use as critical components in life support devices or systems without express written approval of JH.

没有 JH 的书面授权，JH 的产品不能在生命支撑设备或系统里作为关键零件使用。