

FEATURES

- International standard package SOT-227
- Fast switching for high efficiency
- Low forward voltage drop
- Single rectifier construction
- High surge capability
- Component in accordance to RoHS 2015/863/EU

SOT-227

MECHANICAL DATA

- Case: SOT-227
- Molding compound meets UL94V-0 flammability rating
- Polarity: As marked

TYPICAL APPLICATIONS

- Antiparallel diode for high frequency switching devices
- Antisaturation diode
- Snubber diode
- Free wheeling diode
- Rectifiers in switch mode power supplies (SMPS)
- Uninterruptible power supplies (UPS)

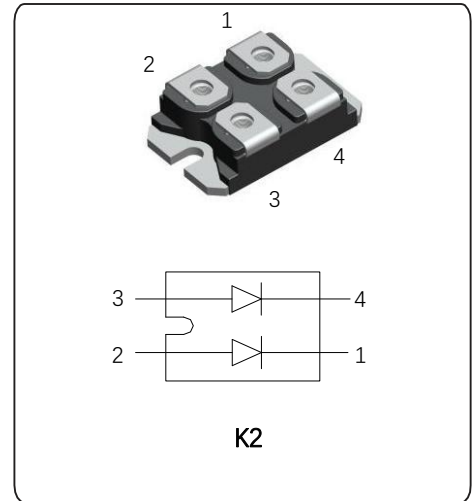

ABSOLUTE MAXIMUM RATINGS

Parameters	Symbol	Test conditions	Value	Unit
Maximum repetitive peak reverse voltage	VRRM		400	V
Maximum Continuous forward current, per pkg per diode	IF	Tc=110°C	30 15	A
Single pulse forward current, per diode	IFSM	Tj=25°C, t=8.3ms, half Sine Wave	200	A
RMS isolation voltage	Viso	AC, t=1min	2500	V
Maximum junction temperature	TJ		150	°C
Maximum reverse recovery time	Trr	IF=0.5A, IR=1A, IRR=0.25A	35	nS
Storage temperture	Tstg		-40 ~ 150	°C
Power Dissipation	PD		156	W

ELECTRICAL CHARACTERISTICS

Parameters	Symbol	Test conditions	Min	Typ	Max	Units
Cathode to anode break down voltage	V _{BR}	I _R =100μA	400	-	-	V
Forward voltage	V _F	I _F =15A, T _J =25°C	-	1.20	1.35	
		I _F =15A, T _J =125°C	-	-	1.25	
Reverse leakage current	I _R	V _R =V _R rated T _J =25°C	-	-	5	uA
		V _R =V _R rated T _J =150°C	-	-	0.5	mA

THERMAL MECHANICAL SPECIFICATIONS

Parameters	Symbol	Test conditions	Min	Typ	Max	Units
Junction to case, single leg conducting	R _{thjc}		-	-	1.30	°C/W
Junction to case, both leg conducting			-	-	0.65	
Case to heatsink	R _{thcs}	Flat, greased surface		0.10		
Weight				30		g
Mounting torque				1.3		Nm
Case style			SOT-227			

ORDERING INFORMATION TABEL

Device code	J	K2	U	30	-	40
	①	②	③	④		⑤

- ① JH 's power module
- ② Circuit Configuration (2 separate diodes, parallel pin-out)
- ③ Ultrafast Rectifier Diodes
- ④ Maximum Average Forward Current (2×15A)
- ⑤ Voltage Rating(40=400V)

FIG.1-TYPICAL FORWARD CURRENT DERATING CURVE

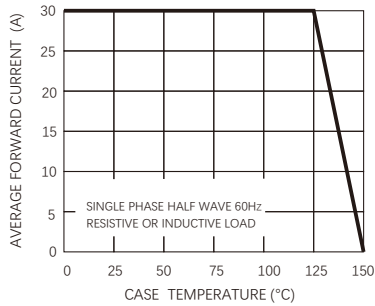

FIG.2-MAXIMUM NON-REPETITIVE FORWARD SURGE CURRENT

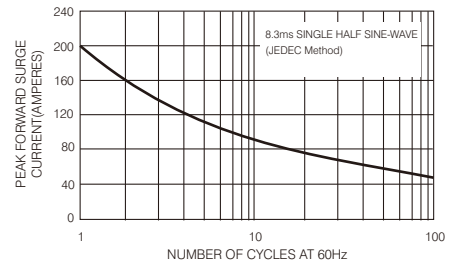

FIG4-TYPICAL FORWARD CHARACTERISTICS

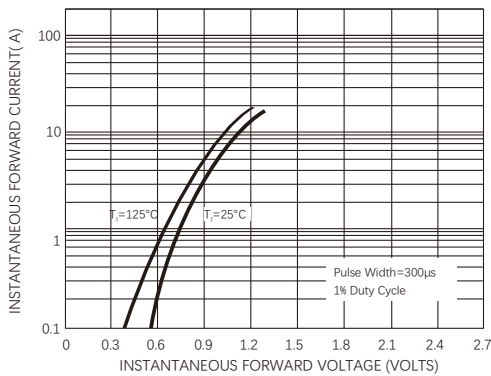
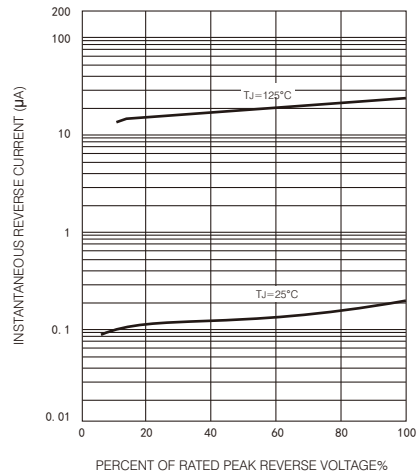
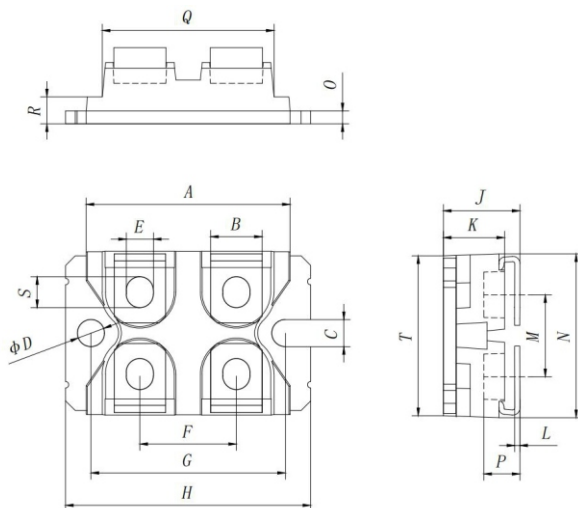

FIG.5-TYPICAL REVERSE CHARACTERISTICS





SYMBOLS	DIMENSION MM		
	MIN	NOM	MAX
<i>A</i>	31.20	31.70	32.20
<i>B</i>	7.50	8.00	8.50
<i>C</i>	3.80	4.20	4.60
<i>D</i>	3.80	4.20	4.60
<i>E</i>	3.80	4.20	4.60
<i>F</i>	14.50	15.00	15.50
<i>G</i>	29.80	30.20	30.60
<i>H</i>	37.70	38.10	38.50
<i>J</i>	11.50	11.90	12.30
<i>K</i>	8.90	9.50	10.00
<i>L</i>	0.75	0.80	0.85
<i>M</i>	12.40	12.70	13.00
<i>N</i>	25.00	25.40	25.80
<i>O</i>	1.70	2.00	2.30
<i>P</i>	4.95	5.60	6.10
<i>Q</i>	26.40	26.70	27.00
<i>R</i>	3.90	4.18	4.45
<i>S</i>	4.20	4.80	5.40
<i>T</i>	23.80	24.80	25.80

Friendship Reminder

- JiNan JingHeng (hereinafter referred to as JH) reserves the right to make changes to this document and its products and specifications at anytime without notice.
- Customers should obtain and confirm the latest product information and specifications before final design, purchase or use.
- JH makes no warranty, representation or guarantee regarding the suitability of its products for any particular purpose, nor does JH assume any liability for application assistance or customer product design.
- JH does not warrant or accept any liability with products which are purchased or used for any unintended or unauthorized application.
- No license is granted by implication or otherwise under any intellectual property rights of JH.
- JH's products are not authorized for use as critical components in life support devices or systems without express written approval of JH.