

FEATURES

- Ultrafast Reverse Recovery Time
- Low Forward Voltage
- High surge capability
- Component in accordance to RoHS 2015/863/EU

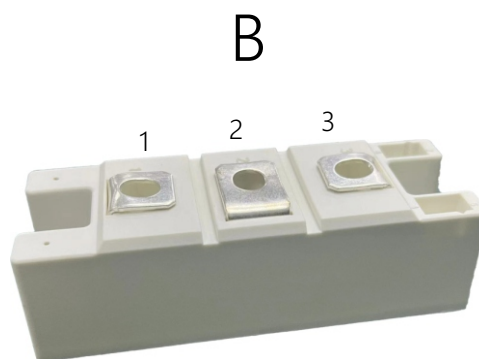

MECHANICAL DATA

- Case: B
- Molding compound meets UL94V-0 flammability rating
- Polarity: As marked

TYPICAL APPLICATIONS

- Inversion Welder
- Uninterruptible Power Supply (UPS)
- Plating Power Supply
- Welders
- Converter & Chopper

Circuit



ABSOLUTE MAXIMUM RATINGS

Parameters	Symbol	Test conditions	Value	Unit
Maximum repetitive peak reverse voltage	V_{RRM}		600	V
Maximum Continuous forward current, per diode	I_F	$T_c=110^{\circ}\text{C}$	300	A
Single pulse forward current, per diode	I_{FSM}	1/2 Cycle, 60Hz, Sine	3200	A
RMS isolation voltage	V_{iso}	AC, $t=1\text{min}$	3000	V
Maximum junction temperature	T_J		150	$^{\circ}\text{C}$
Storage temperature	T_{stg}		-55 ~ 125	$^{\circ}\text{C}$
Power Dissipation	P_D		890	W
Thermal Resistance	$R_{\theta JC}$	Junction-to-Case	0.14	$^{\circ}\text{C/W}$

ELECTRICAL CHARACTERISTICS

Parameters	Symbol	Test conditions	Min	Typ	Max	Units
Cathode to anodebreak down voltage	VBR	$I_R=100\mu A$	600	-	-	V
Forward voltage	VF	$I_F=300A$ $T_J=25^{\circ}C$		1.15	1.65	
		$I_F=300A$ $T_J=125^{\circ}C$		-	1.45	
Reverse leakage current	IR	$V_R=600V$ $T_J=25^{\circ}C$		-	50	μA
		$V_R=600V$ $T_J=125^{\circ}C$		-	500	μA
Reverse Recovery Time	Trr	$I_F=1A$, $V_R=30V$, $dI_F/dt=-200A/\mu s$		55		ns

FIG.1-TYPRCAL FORWARD CURRENT DERATING CURVE

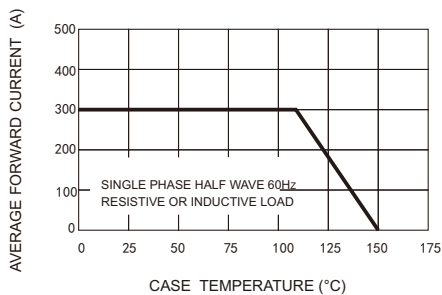

FIG.2-MAXIMUM NON-REPETITIVE FORWARD SURGE CURRENT

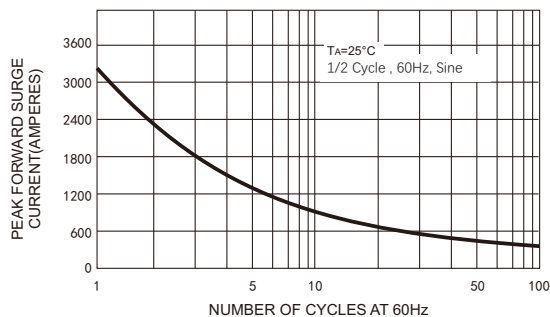

FIG4-TYPICAL FORWARD CHARACTERISTICS

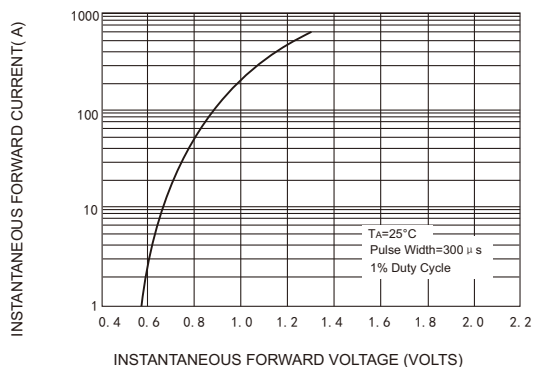
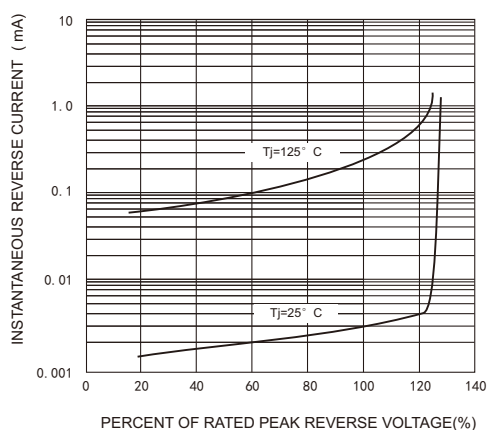
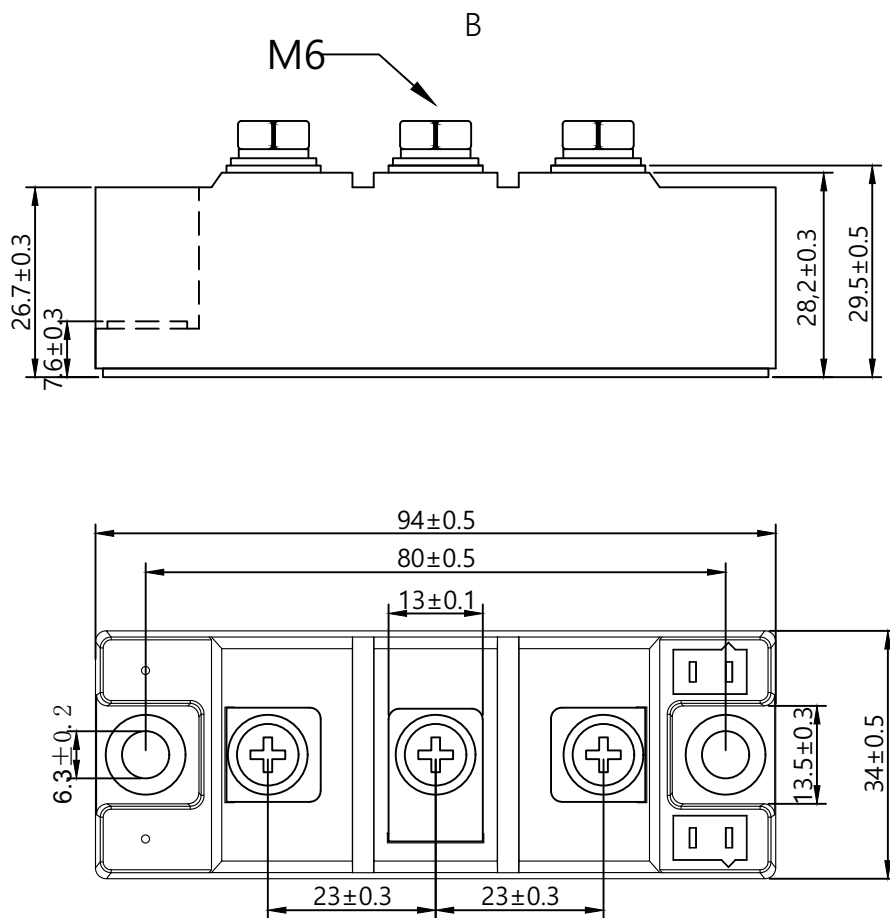

FIG.5-TYPICAL REVERSE CHARACTERISTICS



Package Outline Information



Dimensions in mm

Ordering Information Tabel

J	B1U	300	-	60
①	②	③	④	

- ① JH' s power module
- ② Circuit configuration, U-Ultrafast Rectifier Module, Circuit-1
- ③ Maximum average forward current , 300A
- ④ Voltage code 600V

Friendship Reminder

- JiNan JingHeng (hereinafter referred to as JH) reserves the right to make changes to this document and its products and specifications at anytime without notice.
- Customers should obtain and confirm the latest product information and specifications before final design, purchase or use.
- JH makes no warranty, representation or guarantee regarding the suitability of its products for any particular purpose, nor does JH assume any liability for application assistance or customer product design.
- JH does not warrant or accept any liability with products which are purchased or used for any unintended or unauthorized application.
- No license is granted by implication or otherwise under any intellectual property rights of JH.
- JH's products are not authorized for use as critical components in life support devices or systems without express written approval of JH.