

FEATURES

- Silicon epitaxial planar diode
- Fast switching diode
- 200mW power dissipation
- This diode is also available in other case styles including: the DO-35 case with the type designation 1N4148, the MiniMelf case with the type designation LL4148, the MicroMelf case with the type designation MCL4148, the SOD-123FL case with the type designation 1N4148W, The SOD-523 case with the type designation 1N4148WT.

SOD-323FL



SOD-323



MECHANICAL DATA

- Case: SOD-323FL SOD-323 plastic case
- Marking: T4

MAXIMUM RATINGS AND ELECTRICAL CHARACTERISTICS

(Ratings at 25°C ambient temperature unless otherwise specified)

Parameter	Symbol	Value	Unit
Peak Reverse Voltage	V_{RM}	100	V
Reverse Voltage	V_R	75	V
Average Rectified Forward Current	$I_{F(AV)}$	150	mA
Surge Forward Current ($t < 1$ s, $T_j = 25^\circ\text{C}$)	I_{FSM}	350	mA
Power Dissipation	P_{tot}	200	mW
Thermal Resistance from Junction to Ambient Air	$R_{\theta JA}$	625	$^\circ\text{C/W}$
Junction Temperature	T_j	150	$^\circ\text{C}$
Storage Temperature Range	T_{stg}	- 65 to + 150	$^\circ\text{C}$

ELECTRICAL CHARACTERISTICS

(Ratings at 25°C ambient temperature unless otherwise specified)

Parameter	Symbol	Max.	Unit
Forward Voltage at $I_F = 10$ mA	V_F	0.855	V
Reverse Current at $V_R = 20$ V at $V_R = 75$ V at $V_R = 20$ V, $T_j = 150^\circ\text{C}$	I_R	25 1 50	nA μA μA
Total Capacitance at $V_R = 0$ V, $f = 1$ MHz	C_{tot}	4	pF
Reverse Recovery Time at $I_F = 10$ mA to $I_R = 1$ mA, $V_R = 6$ V, $R_L = 100\ \Omega$	t_{rr}	4	ns

FIG 1-FORWARD CHARACTERISTICS

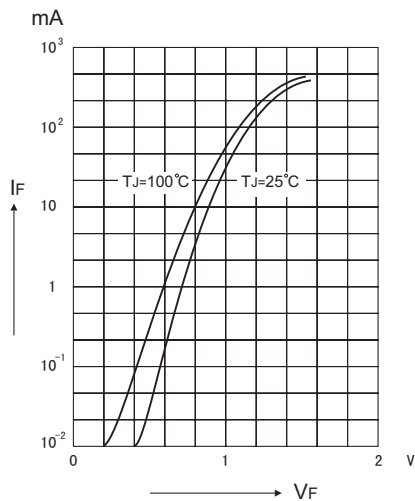

FIG 2: DYNAMIC FORWARD RESISTANCE VERSUS FORWARD CURRENT

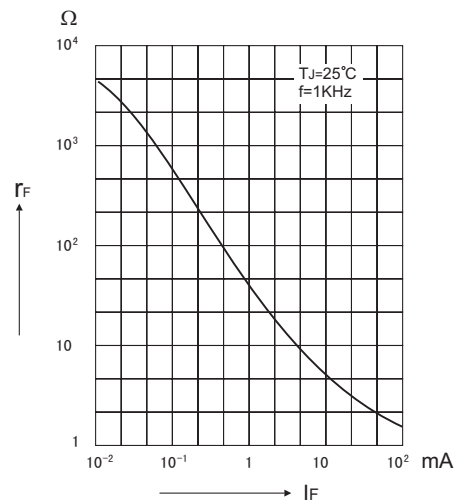

FIG. 3-RELATIVE CAPACITANCE VERSUS VOLTAGE

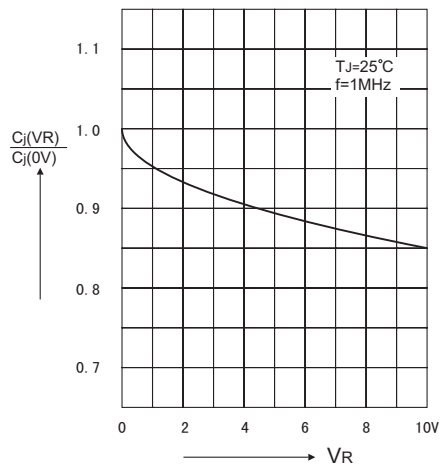
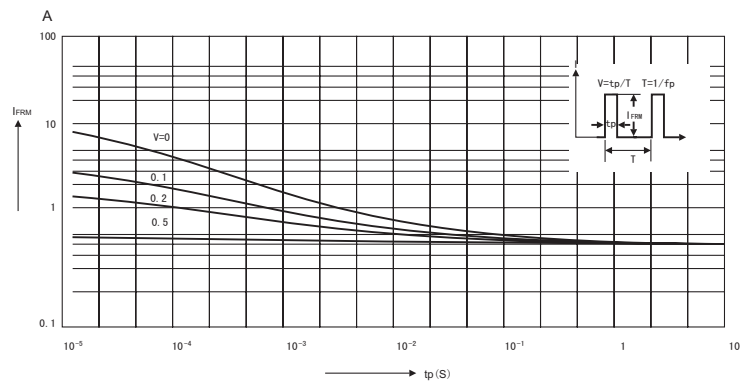
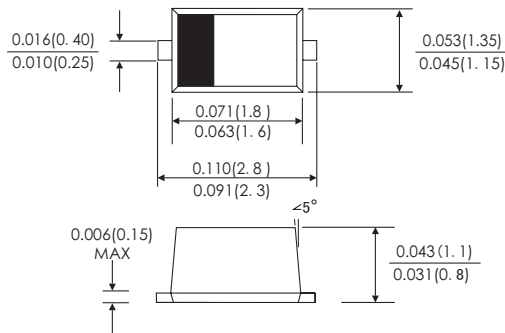

FIG 4: ADMISSIBLE REPETITIVE PEAK FORWARD CURRENT VERSUS PULSE DURATION



SOD-323FL



Dimensions in inches and (millimeters)

SOD-323

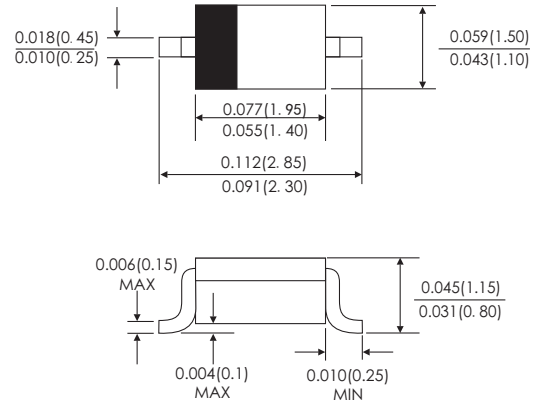

Dimensions in inches and (millimeters)

Friendship Reminder

■ JiNan JingHeng (hereinafter referred to as JH) reserves the right to make changes to this document and its products and specifications at anytime without notice.

■ Customers should obtain and confirm the latest product information and specifications before final design, purchase or use.

■ JH makes no warranty, representation or guarantee regarding the suitability of its products for any particular purpose, nor does JH assume any liability for application assistance or customer product design.

■ JH does not warrant or accept any liability with products which are purchased or used for any unintended or unauthorized application.

■ No license is granted by implication or otherwise under any intellectual property rights of JH.

■ JH's products are not authorized for use as critical components in life support devices or systems without express written approval of JH.